

Total Capacity lbs.				
Wall Top Plate	Clip	Number of Screws Into Bottom Chord	Number of Screws Into Wall Top Plate	Uplift
362T125-54	Clip A	3	4	1050
600T125-54	Clip B	4	6	1600

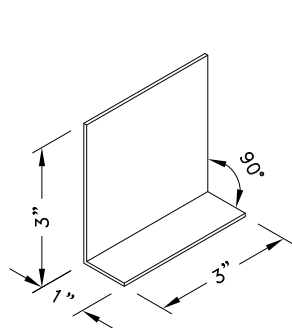

Clip A

16g ASTM A653 SS Grade 33 G60
Bare metal thickness: $t = 0.0538"$

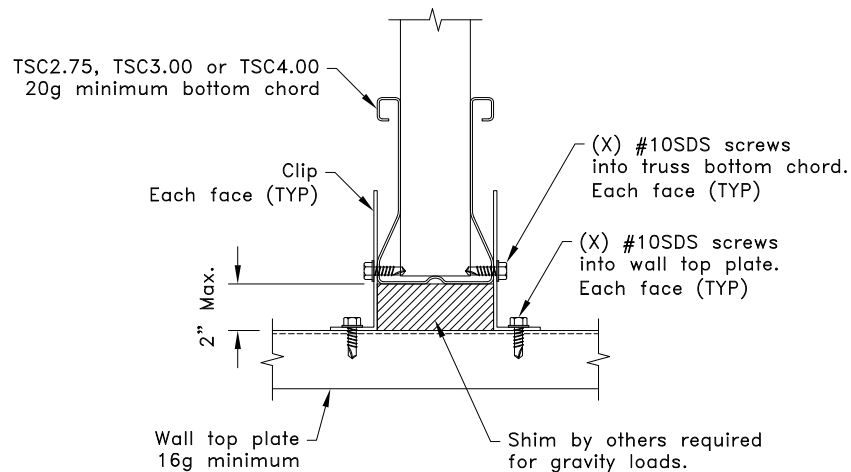
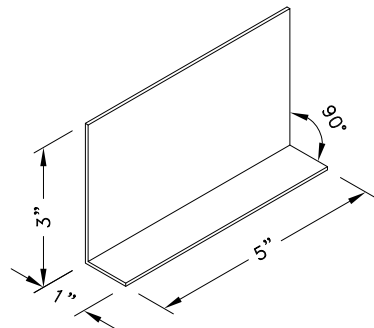

Clip B

16g ASTM A653 SS Grade 33 G60
Bare metal thickness: $t = 0.0538"$

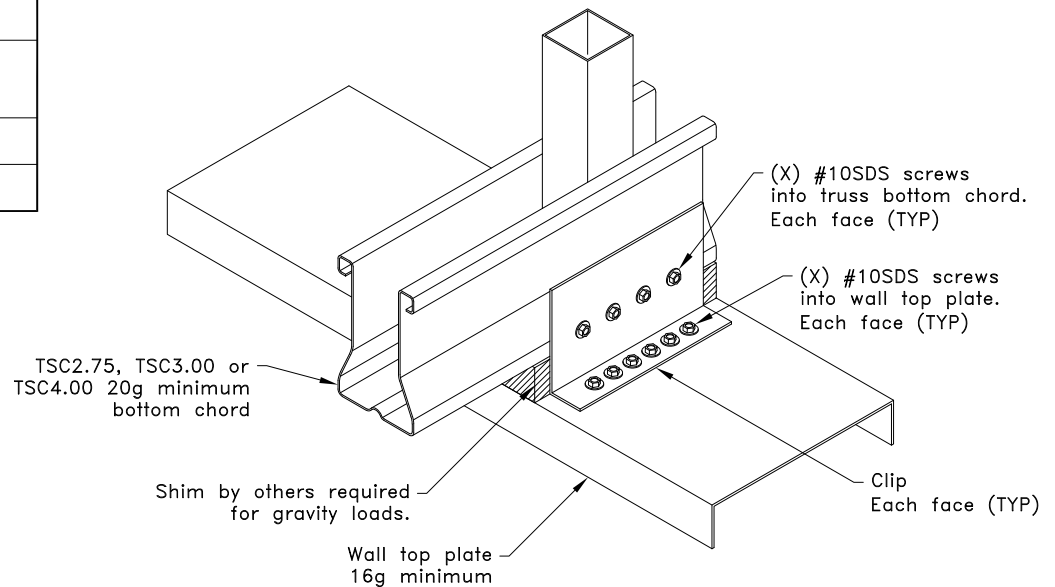

General Notes:

1. SDS = Self-Drilling Tapping Screw
2. Screw end distance and edge distance is $9/32"$ minimum. Screw spacing is $9/16"$ minimum.
3. Wall top plate shall be manufactured from cold-formed steel (CFS) with minimum tensile strength of 45 KSI.
4. Attachment of second clip on opposite face of chord is identical to what is detailed.
5. Connection of top plate to wall stud must be capable of transferring truss uplift load from wall top plate to wall stud.
6. This wall top plate is to be designed by the job engineer. The wall top plate must be designed to support the loads applied to it (downward and upward).
7. Cold-Formed Steel Calculations are per the 2010 addendum to the AISI 2007 "North American Specifications for the Design of Cold-Formed Steel Structural Members" (S100-07/S2-10).

TrusSteel®

www.TrusSteel.com

Florida: 2400 Lake Orange Drive, Suite 150 / Orlando, FL 32837 / (800) 755-6001
Missouri: 13389 Lakefront Drive / Earth City, MO 63045 / (800) 326-4102

Truss Attachment to Cold Formed Steel Wall Top Plate

ITW Building Components Group, Inc. shall not be responsible for any performance failure in a connection due to a deviation from this detail. Any variation from this detail shall be approved in advance by ITW Building Components Group, Inc.

Custom Detail:

CD140112

Date:

02/11/14

Custom Detail Category:

Truss-To-Bearing Connection